

Logiflex - flexible handling of goods

High flexibility and efficiency - with only one truck, goods can be transported, lifted and handled in many different ways.

The design puts focus on the safety and ergonomic working conditions of the user - Logiflex can be adjusted to the individual user, and the ergonomic correct handle ensures the user a relaxed hold.

Optimum utilization of the space - Logiflex is of compact construction and is very maneuverable.

High quality is ensured through an extended test program and in cooperation with experts in Health and Safety.



LOGIFLEX LF MINI / ELF TRANS-STACKER & TRANS-POSITIONER



Technical Specifications

- Optimum safety for the user through
- central location of all control buttons on the handle
 - transparent and impact-resistant safety screen on the mast
 - location of parking brake

Strong construction ensures a long operating life and low maintenance costs.



Ergonomic handle ensures the user a relaxed hold. The handle can be marked with the name/department.



High maneuverability: Short overall length, large turning angle, assisted steering and low own weight.



Adjustable forks are standard for LF Mini and several ELF models.

Available with manual and electric lifting.

Product (measured in inch)	LF MINI TP-MM MINI	LF MINI TS-MM MINI	ELF TP- ME	ELF TS-ME	ELF TP-ME	ELF TS-ME	ELF TS-ME	ELF TS-ME							
Capacity in lbs	2200	2200	2200	2200	3000	3000	3000	3000	2200	2200	2200	2200	2200*		
Lifting height	h ₃	36	65	36	65	36	47	55	63	75	80	96	112	130	
Fork length	l	42, 45		42, 45		23.5**, 31.5**, 45, 60***									
Overall height	h ₁	52.5		52.5			60	68	76	88	60	68	76	88	
Chassis span	b	18.15, 21.25, 26		18.15, 21.25, 26		21.25, 26									
Overall width	b ₁	27		27									36.75		
Width between legs	b ₄	9.30, 12.45, 17.20		9.30, 12.45, 17.20		12.45, 17.20									
Fork span	b ₅	Wrap-over: 13.25-22		Wrap-over: 13.25-22		22, 27									
Length without forks	l ₂	16.35		23.25											
Overall length with 45 forks	l ₁	66	66.25	73.25	73.75	71				71.25					
Overall height	h ₄	52.5	79.75	Without telescopic mast	79.75	Without telescopic mast				98	114	130	148		
Lowered height	h ₁₃	3.25 (fork span 22) 5,75 (fork span 13.25-21.75)		3.25 (fork span 22) 5,75 (fork span 13.25-21.75)		3.25	3.5								
Load centre	c	l/2		l/2											
Fork width	e	6.5		6.5											
Run-in length	l _x	43 with 45 forks		43 with 45 forks											
Gangway (pallet: 47 x 31.5)	A _{st}	86****													
Free lift	h ₂		13		13						7.5				
Turning angle of the wheels		180°		180°											
Pump motor															
Lifting speed		normal/quick: 0.3" / 1" per pump		With/without load: 2 / 2.75" per sec.											
Lowering speed with/without load		max. 2" per sec. / max. 2.8" per sec.		4.75" per sec. / 2.75" per sec.								4.75" / 3" per sec.			
Weight in lbs (without battery)		485	560	524	626	503	531	503	572	594	693	700	742	858	

* Load reduction at large lifting height.

** Maximum lifting height 63" with 23.5" forks, maximum lifting height 96" with 31.5" forks.

*** Reduced capacity 1650 lbs. Not available for 3000 lbs. models.

**** Tests show that 67" are enough.



Available with side-tilting forks and/or optional extras, e.g. drum turner, crane arm, spear, remote control, level control.

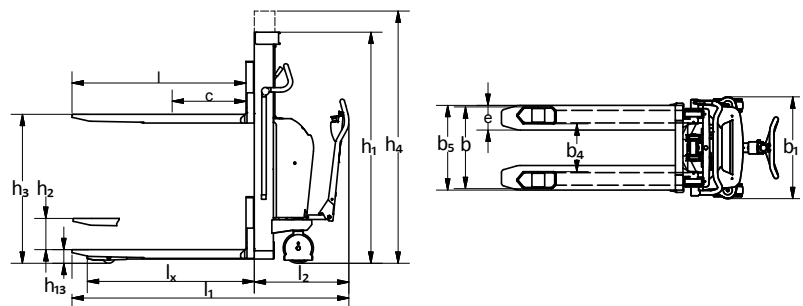

We also offer tailor-made solutions. Please ask for further information.
Please ask for further information or visit our website www.interthor.com



Interthor Inc.
1817 Beach Street - Broadview, IL 60155 - USA
Tel.: 708-345-1270 - Fax: 708-345-1290
www.interthor.com - E-mail: info@interthor.com

www.interthor.com